

四川长仪油气集输设备股份有限公司

Sichuan Changyi Oil-Gas Gathering Transportation Equipment Co.,Ltd



ISO9001、ISO14001、GB/T28001 体系认证企业
With ISO9001, ISO14001, GB/T28001 System
国家特种设备制造许可证号: TS2710413-2018
State Special Equipment Manufacturing
License Number: TS2710413-2018
EAC 认证 Certificate、API 6D 认证 Certificate



(K) TP41Y 型 阀 套 式 排 污 阀

(K) TP41Y Series Drain Valve

获两项国家专利 Two National Patents : ZL02222181.6、 ZL97205605.X
国家重点新产品 State Key Product



TP41Y



TP541Y

Tel: +86 -833-2631000 /+86 -833-2631315
Website: <http://www.cyvalve.com>

Fax: +86 -833-2631316
Email: iscy@vip.163.com

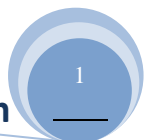

四川长仪油气集输设备股份有限公司

Sichuan Changyi Oil-Gas Gathering Transportation Equipment Co.,Ltd

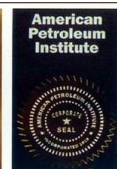
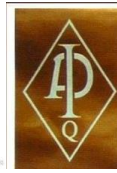
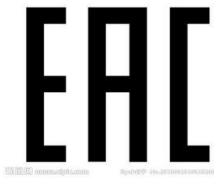

目录 CONTENTS

Production Description	Page
产品简介 Brief Introduction	3
型号说明 Model Explanation	4
技术参数 Technical Parameter	4
性能特点 Performance Feature	5
主要零件材料 Main Spare Parts	6
外形尺寸和连接尺寸 As-built Dimension and Connection	7

四川长仪油气集输设备股份有限公司

Sichuan Changyi Oil-Gas Gathering Transportation Equipment Co.,Ltd

1. 产品简介 Brief Introduction

该产品经过二次、三次开发，现已推出第五代新型结构的排污阀门，采用节流轴与阀座喷嘴、套垫窗口与阀座通道、阀芯底端与阀套窗口的多级节流技术，完全打破了传统的排污阀结构功能原理。具有密封零泄漏、耐冲刷、防堵塞、密封面自清扫、节流降压、满足大颗粒杂质排放等优良性能，特别能满足恶劣工况条件下的排污要求，使用寿命比传统排污阀高 8-10 倍。投放市场 20 多年以来，取得了良好的使用业绩。经国内石油天然气工程专家鉴定，技术水平国际先进，填补了阀类空白，获 2004 年国家重点新产品。可广泛用于石油、天然气、化工、冶金等领域管道集输装置直接排污。

抗硫合金、陶瓷节流部件与特殊密封副结构产品可满足高压差、高含 H₂S、CO₂、CL⁻介质条件下耐冲刷、防腐蚀的使用要求。

应用业绩：西气东输工程；中石油塔里木油田分公司克拉 II 气田、桑南吉拉克、英买力气田、塔中 6 凝析气田建设；长庆油田分公司长北气田；西南油气田分公司；罗家寨特高含硫气田；青海涩北气田；中海油东方 1-1 陆上终端、渤南陆上终端、海南环岛输气管线；西部成品原油管线；中奥合作广东 LNG 液化天然气项目；上海浦东城市输气管网等。

TP41Y Series now are in the fifth generation after the second and third research and development. This new structure adopts multiple throttling technologies and throttling happens at the contact positions between throttle axis& nozzle of valve seat, between sleeve gasket window & valve seat orifice, between spool bottom and sleeve window respectively. This new structure features reliable sealing, enduring brush, anti-jam, self-cleaning, dual functions of throttling and depressurization, draining of macro residues. The new product is especially up to the severe draining condition and service life is 8 to 10 times than conventional draining valve. 20-year performance has made TP41Y Series renowned and appraised by project expert of domestic petroleum gas, awarded as national key product of 2004. TP41Y Series are applicable for direct draining of piping device in the fields such as petroleum, natural gas, chemical industry, and metallurgy, etc.

TP41Y Series with anti-sulfur alloy and ceramic seal is up to scour-resistant and erosion-resistant requirements when pressure difference is high or the media contains high H₂S、CO₂ and CL.

Project Achievements: West-to-East NG(NG) Pipeline Project, karat II Gas Field of CNPC Tarim Oil Field, Sangnan-Jilake Gas Field, YingMaiLi Gas Field, Tazhong 6 Condensate Gas Field, Changbei Gas Field of Changqing Oil Field, Southwest Oil & Gas Field, LuoJiazai High-Sulfur Gas Field, Qinghai SeBei Gas Field, Orient 1-1 Land Terminal of CNPOOC , Land Terminal Of Bohai Sea, Hainan Ring Island Gas Pipeline, West Finish Crude Oil Pipeline, Sino-Australia Guangdong LNG Project, Shanghai Pudong City Gas Network, etc.

四川长仪油气集输设备股份有限公司

Sichuan Changyi Oil-Gas Gathering Transportation Equipment Co.,Ltd

2. 型号说明 Model explanation

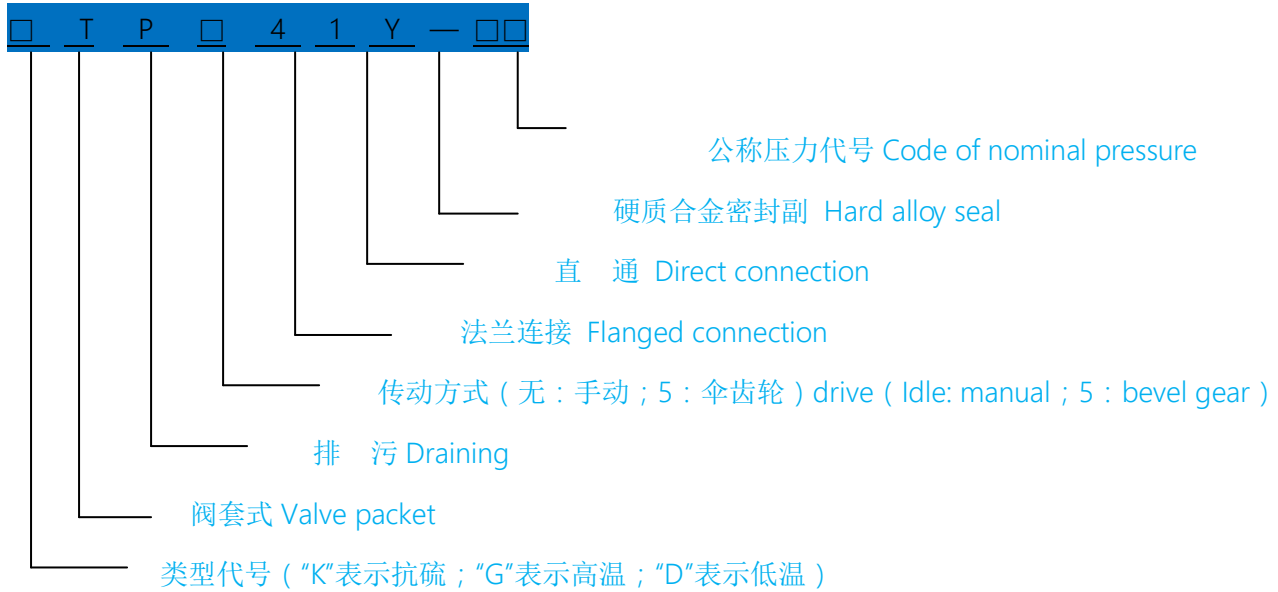

Model code (K=anti-sulfur ; G = high temperature ; D = low temperature)

3. 技术参数 Technique parameters

公称压力 PN Nominal Pressure	1.6~25.0MPa (ANSI 150Class~1500Class)
公称通径公称通径 DN Nominal diameter	15~250mm (NPS 1/2" ~10 ")
使用介质温度 Applicable Media Temperature	普通型 General type: -29℃~130℃; 高温型 high temperature type: 130℃~350℃; 低温型 low temperature type: -101℃~-29℃。(高温、低温型适用的公称压力和公称通径根据实际工况条件确定。高温、低温型适用的公称压力和公称通径根据实际工况条件确定 The applicable PN and DN under high temperature and low temperature will be determined by the practical work condition)
适用介质 Applicable Media	油品、净化天然气、含硫天然气 (H ₂ S+CO ₂ ≤8mol%)、高含硫天然气 (H ₂ S+CO ₂ ≤21mol%)、城市煤气等。 Oil, Purified NG, Sour gas (H ₂ S+CO ₂ ≤8mol%) , High -Sulfur NG (H ₂ S+CO ₂ ≤21mol%) , City gas, etc..
传动方式 Driving Method	手动、电动、伞齿轮传动 (可根据用户要求选择其它传动方式可根据用户要求选择其它传动方式) By Manual / By electricity / By Bevel gear (Available to have customized choose)
执行标准 standard	结构长度 Structure length: ANSI B16.10、GB/T12221-2005 连接法兰 Flange: ANSI B16.5、JB/T79-94、HG20592~20635、GB/T9113-2000 检验测试 Test: API 598、GB/T13927 -92、JB/T9092-99 抗硫阀 Anti-sulfur valve: NACE MR 0175-2002、SY/T0599-2006

Tel: +86 -833-2631000 /+86 -833-2631315
Website: <http://www.cyvalve.com>

Fax: +86 -833-2631316
Email: iscy@vip.163.com

可根据用户特殊要求设计制造。It's available to have the customized design and manufacture.

4. 性能特点 Performance Features

4.1 密封可靠：硬软双质密封，保证气、液介质“零泄漏”。

Reliable Seal: Hard and soft seal makes the high-pressure gas and liquid media “zero leakage”.

4.2 节流功能：采用节流轴与阀座喷嘴、套垫窗口与阀座通道、阀芯底端与阀套窗口的多级节流结构设计，既能满足排污流量的变化，又能满足不同工况的需要，而且有效缓减了含湿气和沙粒较重的介质对阀芯密封副的冲刷。

Throttling Function: Multiple throttling structures between throttle axis& nozzle of valve seat, between sleeve gasket window & valve seat orifice and between spool bottom & sleeve window respectively are up to the draining volume changes as well as effectively mitigate the erosion of humid and macro solid Medias on the surface of spool seal.

4.3 缓压空行程：在节流轴和阀座喷嘴、套垫与阀座内腔、阀芯与阀套下端配合处分别设有一段等距同步缓压空行程，使得阀芯离开阀座密封面有足够空间距离时，介质才开始节流、排放，降低了密封面受到的冲刷力，有效保护密封面。

The Travel of Relief Finale: The idle Travels between throttle axis& nozzle of valve seat, between sleeve gasket window & valve seat orifice and between spool bottom & sleeve window is with equidistance synchronization features. It ensures that the medium would start throttling and discharging medium as long as enough room and distance is kept when spool is off from the seat seal. It can effectively protect sealing surface.

4.4 自清扫功能：阀门关闭过程中，套垫与阀座通道的配合间隙阻止较大颗粒介质流向密封付，介质从套垫斜角处进入阀座通道，流阻系数增加，流速加快，阀座端面介质径向力增加，实现阀座密封面的吹扫；阀芯底部凹槽处由于介质改变流向产生涡流，实现软密封副的自吹扫，从而避免了硬软密封面粘附杂质，保证了阀门排污后的密封性能。

Self-Cleaning function: In process of closing valve, the gap between seat gasket and valve seat can prevent macro media from flowing into seal; the media can flow into valve seat orifice through bevel angle of gasket with higher flow resistance coefficient and flow rate, larger radial force of medium to achieve the sealing surface's purging of valve seat. Under spool bottom, the diversion of media flow causes whirlpool, which can purge soft seal, avoid the residues adhesion on the hard and soft sealing surface, and ensure the sealing performance after draining.

4.5 排污功能：排放时，阀门内部设置的缓压空行程，避开了开启时高压差介质的直接冲刷，能有效保护密封面，延长阀门使用寿命。阀门关闭过程中，硬、软双质密封面的自清扫，避免了硬、软双质密封面粘附杂质，防止了关闭后密封面被划伤，保证密封可靠，满足恶劣工况条件下排污使用要求。

Draining Function: When draining media, the idle travel of relief finale avoid the direct scour due to media with high-pressure differential, and can effectively protect sealing surface, extend service life. In process of closing valve, the self cleaning of hard and soft surface can avoid the scratch of sealing face and

四川长仪油气集输设备股份有限公司

Sichuan Changyi Oil-Gas Gathering Transportation Equipment Co.,Ltd

ensure reliable sealing up to the draining requirements under poor working conditions.

4.6 自动除渣功能：阀芯两道 O 形圈之间设有储渣槽，当第一道 O 形圈损坏，介质中杂质进入储渣槽，实现自动除渣，使阀芯外圆及阀套内壁随时保证清洁，避免了第二道 O 形圈被划伤，保证密封可靠。

Auto Clean Residues: Spool with two O-rings owns a residue collection slot, and when the 1st O-ring is broken, the residues of media would flow into slot for auto cleaning, keep external circle of spool and inwall of sleeve at clear status, and further avoid the scratch of 2nd O-ring and ensure a reliability sealing..

4.7 阀芯开设平衡孔，使启闭扭矩小，开启轻便灵活。

The balance whole and residues slot keep small torque, easy and flexible open.

4.8 阀杆上装有注脂嘴，并在密封填料间设置了 O 形密封圈与聚四氟乙烯填料交叉作用，保证阀杆处不泄露，延长阀杆使用寿命。

Valve stem is equipped with grease injector nozzle, and the interaction of O-ring and PTFE between seal and padding ensure the zero leakage and further extend stem life.

5. 主要零件材料 Major Spare Parts

零件名称 Part name	普通型 Conventional type	抗硫型 Sulfur resisting	高温型 High temperature	低温型 Low temperature
阀体、阀盖 Valve body Bonnet	WCB、20			LCB、CF8、316、316L、1Cr18Ni9Ti
阀芯、阀座 Needle base	2Cr13 密封面堆焊 Stellite 合金 2Cr13 bead welding Satellite alloy	抗硫硬质合金 Sulfur resistant hard alloy	2Cr13 密封面堆焊 Stellite 合金 2Cr13 bead welding Satellite alloy	304 密封面堆焊 Stellite 合金 304 bead welding Satellite alloy
阀杆 Stem	2Cr13	抗硫不锈钢 Sulfur resisting stainless steel	2Cr13	不锈钢 Stainless steel
阀芯套 Plate	2Cr13	抗硫不锈钢 Sulfur resisting stainless steel	2Cr13	不锈钢 Stainless steel
软密封 Soft seal	聚四氟乙烯 PTFE	聚四氟乙烯 PTFE	增强 PTFE Enhanced PTFE	聚四氟乙烯 PTFE
填料 Padding	聚四氟乙烯 PTFE		柔性石墨 Soft graphite	聚四氟乙烯 PTFE
阀杆螺母 Flange nut	铜合金 Aldary			

四川长仪油气集输设备股份有限公司

Sichuan Changyi Oil-Gas Gathering Transportation Equipment Co.,Ltd

法兰螺栓 Flange bolt	35CrMoA
法兰螺母 Flange nut	35、30CrMo

6. 外形尺寸和连接尺寸 As-built Dimension and Connection

6.1 结构见图1 For structure, see Fig.1

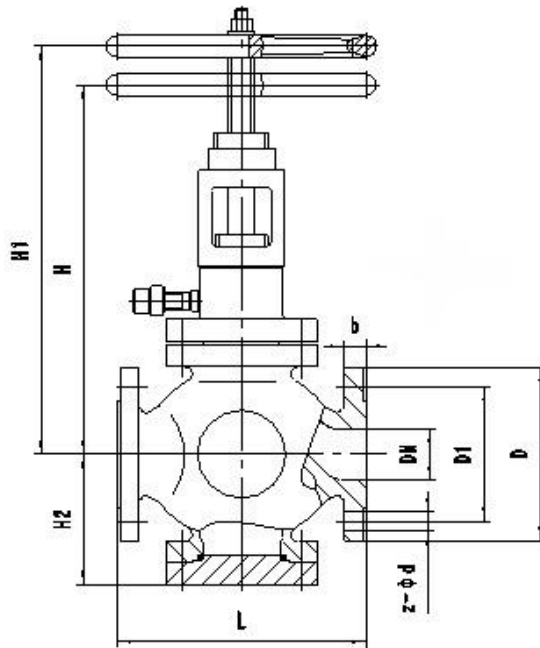

注: DN≤65 不设下盖, 底部排污孔用螺塞。

Notice: bottom cover is not available if DN is ≤65 . The bottom draining hole is with plug screw.

图1 (K) TP41Y 型阀套式排污阀结构简图 Fig.1 (K) TP41Y Draining Valve Structure Drawing

6.2 安装尺寸见表1~表4 (法兰标准及密封面型式可按用户订货要求)

For installation dimensions, see Table 1~4 (The manufacture of flange dimension and sealing surface are customized).

表 Table 1

(K) TP41Y

ANSI 150Class~400Class

Tel: +86 -833-2631000 / +86 -833-2631315
Website: <http://www.cyvalve.com>

Fax: +86 -833-2631316
Email: iscy@vip.163.com

四川长仪油气集输设备股份有限公司

Sichuan Changyi Oil-Gas Gathering Transportation Equipment Co.,Ltd

压力等级 (Class)	公称通径 (NPS)	连接尺寸 (mm) Connection Dimension								重量 Mass ≈Kg
		L	D	D1	b	H	H1	H2	Z-φ d	
150	1/2	165	89	60.5	10	221	238	82	4-16	8
	3/4	190	98	70	11	238	260	77	4-16	10
	1	216	108	79.5	12	243	262	86	4-16	12
	1-1/4	229	117	89	13	255	270	90	4-16	16
	1-1/2	241	127	98.5	15	265	295	108	4-16	22
	2	229	152	120.5	16	345	396	110	4-18	25
	2-1/2	292	178	139.5	18	361	417	130	4-18	40
	3	305	190	152.5	19	409	471	146	4-18	70
	4	350	229	190.5	24	433	502	163	8-18	80
	5	400	254	216	24	484	540	210	8-22	95
	6	495	279	241.5	26	521	611	220	8-22	188
	8	600	343	298.5	29	594	729	292	8-22	290
10	730	406	362	31	621	798	355	12-26	550	
300	1/2	165	95	66.5	15	221	238	82	4-16	8
	3/4	190	117	82.5	16	238	260	77	4-18	11
	1	216	124	89	18	243	262	86	4-18	13
	1-1/4	229	133	98.5	19	255	289	98	4-18	18
	1-1/2	241	156	114.5	21	265	295	108	4-22	22
	2	229	165	127	23	346	396	115	8-18	26
	2-1/2	292	190	149	26	361	417	130	8-22	42
	3	356	210	168.5	29	409	471	146	8-22	68
	4	406	254	200	32	433	502	163	8-22	85
	5	400	279	235	35	484	540	210	8-22	95
	6	495	318	270	37	521	611	220	12-22	185
	8	600	381	330	42	594	729	292	12-26	322
10	730	445	387.5	48	621	798	360	16-30	600	
400	1/2	165	95	66.7	21.5	221	238	85	4-16	9
	3/4	190	118	82.5	23	238	260	81	4-18	12
	1	216	124	88.9	24.5	254	274	86	4-18	15
	1-1/4	229	133	98.4	28	255	289	90	4-18	20
	1-1/2	241	156	114.3	29.5	265	295	108	4-22	25



Tel: +86 -833-2631000 / +86 -833-2631315
Website: <http://www.cyvalve.com>

Fax: +86 -833-2631316
Email: iscy@vip.163.com



四川长仪油气集输设备股份有限公司

Sichuan Changyi Oil-Gas Gathering Transportation Equipment Co.,Ltd

2	292	165	127	32.5	346	396	120	8-18	29
2-1/2	292	190	149.2	36	361	417	138	8-22	40
3	356	210	168.3	39	409	471	152	8-22	65
4	406	254	200	42	433	502	169	8-26	90
5	400	279	234.9	45.5	484	540	210	8-26	100
6	495	318	269.9	48.5	521	611	225	12-26	187
8	597	381	330.2	55	641	776	299	12-30	350
10	787	445	387.3	61	705	862	420	16-33	581



表 Table 2

(K) TP41Y

ANSI 600Class ~ 2500Class

压力等级 (Class)	公称通径 (NPS)	连 接 尺 寸 (mm) Connection dimension								重量 Mass ≈Kg
		L	D	D1	b	H	H1	H2	Z-φd	
600	1/2	210	95	66.5	22	225	238	82	4-16	10
	3/4	229	118	82.5	23	235	260	81	4-18	13
	1	216	124	89	25	245	269	78	4-18	15
	1-1/4	229	133	98.5	28	260	295	103	4-18	25
	1-1/2	241	156	114.5	30	265	300	106	4-22	30
	2	292	165	127	33	287	317	110	8-18	36
	2-1/2	340	190	149	36	360	417	140	8-22	65
	3	359	210	168	39	409	471	152	8-22	77
	4	435	273	216	45	433	502	169	8-26	107
	5	500	330	266.5	52	490	560	220	8-30	130
	6	559	356	292	55	531	621	225	12-30	238
	8	664	419	349	63	709	801	321	12-33	422
10	787	508	432	71	817	930	399	16-36	690	
900	1/2	210	121	82.5	29.5	221	238	82	4-22	13
	3/4	210	130	88.9	32.5	238	260	81	4-22	18
	1	254	149	101.6	36	245	269	78	4-26	27
	1-1/4	260	159	111.1	36	260	295	108	4-26	35
	1-1/2	260	178	123.8	39	265	300	106	4-30	40
	2	300	216	165.1	45.5	287	317	110	8-26	45
	2-1/2	356	244	190.5	48.5	360	417	140	8-30	69

四川长仪油气集输设备股份有限公司

Sichuan Changyi Oil-Gas Gathering Transportation Equipment Co.,Ltd

	3	384	241	190.5	45.5	414	476	156	8-26	96
	4	460	292	234.9	51.5	440	506	175	8-33	132
	6	613	381	317.5	63	590	680	232	12-33	304
	8	737	470	393.7	70.5	712	807	326	12-39	500
	10	787	545	469.9	77	817	926	355	16-39	856
1500	1/2	216	121	82.5	29.5	220	260	70	4-22	20
	3/4	230	130	88.9	32.5	240	260	81	4-22	25
	1	254	149	101.6	36	225	269	85	4-26	28
	1-1/4	254	159	111.1	36	255	276	90	4-26	41
	1-1/2	305	178	123.8	39	295	317	112	4-30	54
	2	368	216	165.1	45.5	287	317	125	8-26	78
	2-1/2	419	244	190.5	48.5	361	417	138	8-30	125
	3	470	267	203.2	55	422	452	194	8-33	170
	4	546	311	241.3	61	467	500	214	8-36	265
	6	711	394	317.5	90	594	635	318	12-39	466

注：ANSI 150Class ~ 1500Class 法兰尺寸按 ANSI B16.5 标准,密封面采用 RF 面或 RJ 面。

Notice : Flanges of ANSI 150Class ~ 2500Class adopt ANSI B16.5 standard, sealing face is RF or RJ.

表 Table 3

(K) TP41Y-16 ~ 63

PN1.6 ~ 6.3MPa

公称压力 PN (MPa) Nominal pressure	公称通径 DN (mm) Nominal diameter	连 接 尺 寸 (mm) Connection dimension								重量 Mas s ≈ kg	法兰标准 flange standard
		L	D	D1	b	H	H1	H2	Z-φd		
1.6	15	165	95	65	14	221	238	82	4-14	8	JB/T79.1-94 凸面 (RF)
	20	190	105	75	14	238	260	77	4-14	10	
	25	216	115	85	14	243	262	86	4-14	12	
	32	229	135	100	16	255	270	90	4-18	16	
	40	240	145	110	16	265	295	108	4-18	22	
	50	230	160	125	16	345	396	110	4-18	25	
	65	290	180	145	18	361	417	130	4-18	40	

四川长仪油气集输设备股份有限公司

Sichuan Changyi Oil-Gas Gathering Transportation Equipment Co.,Ltd

	80	310	195	160	20	409	471	14	8-18	70		
								6				
	100	350	215	180	20	433	502	163	8-18	80		
	125	400	245	210	22	484	540	210	8-18	95		
	150	480	280	240	24	521	611	22	8-23	188		
								0				
	200	600	335	295	26	594	729	29	12-23	290		
								2				
	250	730	405	355	30	621	798	35	12-25	550		
								5				
2.5	15	165	95	65	16	221	238	82	4-14	8	JB/T79.1-94 凸面 (RF)	
	20	190	105	75	16	238	260	77	4-14	10		
	25	216	115	85	16	243	262	86	4-14	12		
	32	229	135	100	18	255	270	90	4-18	16		
	40	240	145	110	18	265	295	108	4-18	22		
	50	230	160	125	20	345	396	110	4-18	25		
	65	290	180	145	22	361	417	130	8-18	40		
	80	310	195	160	22	409	471	14	8-18	70		
									6			
	100	350	230	190	24	433	502	163	8-23	85		
	125	400	270	220	28	484	540	210	8-25	100		
	150	480	300	250	30	521	611	22	8-25	190		
									0			
200	600	360	310	34	594	729	29	12-25	300			
								2				
250	730	425	370	36	621	798	35	12-30	560			
								5				
4.0	15	165	95	65	16	221	238	82	4-14	8	JB/T79.2-94 凹 凸 面 (MF)	
	20	190	105	75	16	238	260	77	4-14	10		
	25	216	115	85	16	243	262	86	4-14	12		
	32	229	135	100	18	255	289	98	4-18	16		
	40	240	145	110	18	265	295	108	4-18	22		
	50	230	160	125	20	346	396	115	4-18	25		
	65	290	180	145	22	361	417	130	8-18	40		

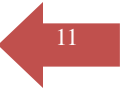

四川长仪油气集输设备股份有限公司

Sichuan Changyi Oil-Gas Gathering Transportation Equipment Co.,Ltd

	80	310	195	160	22	409	471	14	8-18	70	
								6			
	100	350	230	190	24	433	502	163	8-23	85	
	125	400	270	220	28	484	540	210	8-25	100	
	150	480	300	250	30	521	611	22	8-25	190	
								0			
	200	600	375	320	38	594	729	29	12-30	300	
								2			
	250	730	445	385	42	621	798	36	12-34	560	
								0			
6.3	15	165	105	75	18	221	238	85	4-14	10	JB/T79.2-94 凹 凸 面 (MF)
	20	190	125	90	20	238	260	81	4-18	13	
	25	216	135	100	22	254	274	86	4-18	16	
	32	229	150	110	24	255	289	90	4-23	23	
	40	240	165	125	24	265	295	108	4-23	26	
	50	230	175	135	26	346	396	120	4-23	31	
	65	290	200	160	28	361	417	138	8-23	42	
	80	310	210	170	30	409	471	152	8-23	65	
	100	350	250	200	32	433	502	169	8-25	90	
	125	400	295	240	36	484	540	210	8-30	105	
	150	480	340	280	38	521	611	22	8-34	195	
								5			
	200	600	405	345	44	641	776	29	12-34	360	
								9			
	250	730	470	400	48	705	862	42	12-36	600	
								0			



表 Table 4

(K) TP41Y-100 ~ 250

PN10.0 ~ 25.0MPa

公称压力 (MPa)	公称通径 (mm)	连 接 尺 寸 (mm) Connection dimension								重 量 Mas	法兰标准 flange standard
		L	D	D1	b	H	H1	H2	Z-φd		

Tel: +86 -833-2631000 / +86 -833-2631315
Website: <http://www.cyvalve.com>

Fax: +86 -833-2631316
Email: iscy@vip.163.com

四川长仪油气集输设备股份有限公司

Sichuan Changyi Oil-Gas Gathering Transportation Equipment Co.,Ltd

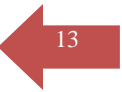

Nominal pressure	Nominal diameter									s ≈ kg	
10.0	15	210	105	75	26.5	225	238	82	4-14	11	JB/T79.4-94 环连接面 (RJ)
	20	230	125	90	28.5	235	260	81	4-18	14	
	25	216	135	100	30.5	245	269	78	4-18	17	
	32	229	150	110	30.5	260	295	103	4-23	26	
	40	260	165	125	32.5	265	300	106	4-23	32	
	50	300	195	145	36	287	317	110	4-25	38	
	65	340	220	170	40	360	417	140	8-25	70	
	80	380	230	180	42	409	471	152	8-25	80	
	100	430	265	210	46	433	502	169	8-30	110	
	125	500	310	250	50	490	560	220	8-34	135	
	150	559	350	290	54	531	621	225	12-34	240	
	200	660	430	360	62	709	801	321	12-36	430	
	250	787	500	430	68	817	930	399	12-41	690	
16.0	15	210	110	75	30.5	221	238	82	4-18	15	JB/T79.4-94 环连接面 (RJ)
	20	210	130	90	32.5	238	260	81	4-23	18	
	25	254	140	100	34.5	245	269	78	4-23	28	
	32	260	165	115	36.5	260	295	108	4-25	37	
	40	260	175	125	38.5	265	300	106	4-27	41	
	50	300	215	165	44	287	317	110	8-25	45	
	65	356	245	190	52	360	417	140	8-30	69	
	80	390	260	205	54	414	476	156	8-30	100	
	100	450	300	240	56	440	506	175	8-34	133	
	150	613	390	318	76	590	680	232	12-41	306	
	200	737	480	400	89	712	807	32	12-48	505	

四川长仪油气集输设备股份有限公司

Sichuan Changyi Oil-Gas Gathering Transportation Equipment Co.,Ltd

								6			
	250	787	580	485	99	817	926	35	12-54	860	
								5			
25.0	15	216	120	82.5	28.9	220	260	70	4-22	20	GB/T9113.4 -2000RJ 面
	20	230	130	89	31.9	240	260	81	4-22	25	
	25	254	150	101.5	35.4	225	269	85	4-26	28	
	32	254	160	111	35.4	255	276	90	4-26	41	
	40	305	180	124	38.4	295	317	112	4-30	54	
	50	368	215	165	46.4	287	317	125	8-26	78	
	65	419	245	190.5	49.4	361	417	138	8-30	125	
	80	470	265	203	56	422	452	19	8-33	170	
	100	546	310	241.5	62	467	500	21	8-36	265	
	150	711	395	317.5	92.5	594	635	318	12-39	466	

